

EASTERN DIVISION



Department for

**Infrastructure**

An Roinn

**Bonneagair**

Department for

**Infrastructure**

[www.infrastructure-ni.gov.uk](http://www.infrastructure-ni.gov.uk)

Local Planning Office  
Belfast City Council  
Cecil Ward Building  
4-10 Linenhall Street  
BELFAST  
BT2 8BP

Annexe 7, Block 2  
Castle Buildings  
Stormont Estate  
Upper Newtownards Road  
BELFAST  
BT4 3SQ

Telephone: 0300 200 7899  
Textphone number: 028 9054 0022

Being Dealt With By: Sandra Connolly

Email: [Sandra.connolly@infrastructure-ni.gov.uk](mailto:Sandra.connolly@infrastructure-ni.gov.uk)

Direct Line: 02890 526162

Your Ref:

Our Ref: MD2/Z/03/1103

Date: 10 October 2022

Dear Sir/Madam

**ROADS (NI) ORDER 1993  
PROPOSED ABANDONMENT OF FOOTPATH AT 312-320 ORMEAU ROAD, BELFAST**

DFI Roads has received an application from T.J McGurran Ltd (The Errigle Inn) proposing to abandon the portion of footway as shown hatched/highlighted on the attached map.

The abandonment is necessary to incorporate this portion of footway within the seating area of the Public House.

Please let me have your comments on the above proposal.

If I do not receive your reply I shall assume you have no objection and will proceed accordingly.

Yours faithfully

Sandra Connolly  
Lands Section

ENC





# PLANNING ISSUE

# Alastair Coey Architects

HISTORIC BUILDINGS SPECIALISTS

Belmont Gate Lodge, 96 Sydenham Avenue, Belfast BT4 2DT, Northern Ireland  
 Tel: (028) 9087 2400 Fax: (028) 9087 2401 E-mail: info@alastaircoeyarchitects.com

Project

**REFURBISHMENT OF THE ERRIGLE**  
 at 312 - 320 ORMEAU ROAD  
 for PHIL MCGURRAN

Drawing title

**Site location plan**

SITE OUTLINED IN RED  
 ADJOINING PROPERTY OWNED BY APPLICANT OUTLINED IN BLUE  
 RIGHT OF WAY OUTLINED IN GREEN  
 AREA TO BE ABANDONED HATCHED



Project Reference  
**EIP06**

Drawing number  
**AO-01**

Revision

B				
---	--	--	--	--

Scale: 1:1250

Date drawn: OCT 2021

Drawn by: PER

Checked by: ###

O.S Map Ref: XXX XX

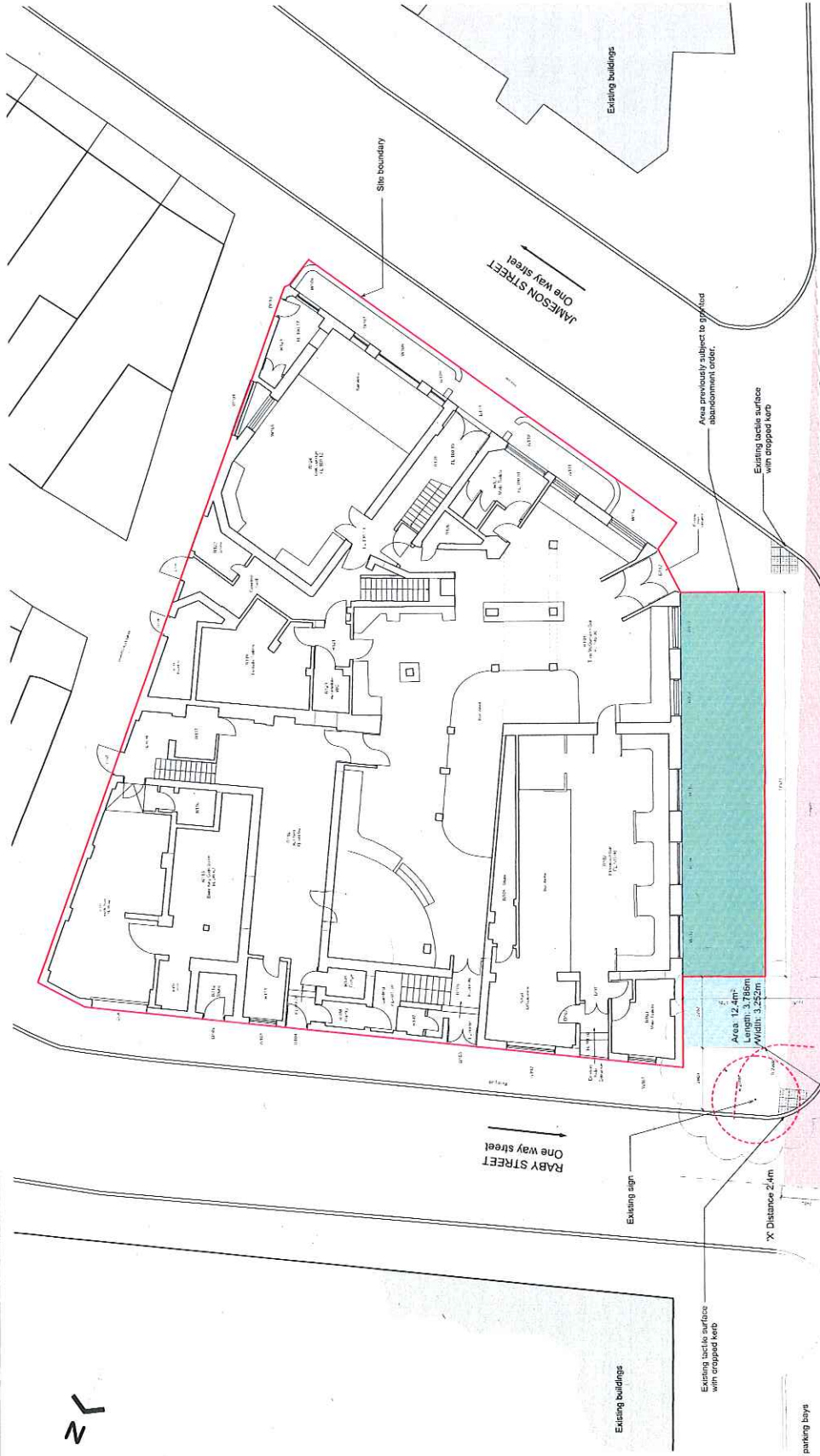

**BCC**  
**DEPARTMENT FOR**  
**PLACE AND ECONOMY**  
**RECEIVED**  
  
**14 OCT 2022**  
  
**BELFAST PLANNING**  
**SERVICE**

Y Distance 43m  
Based on SSD 40m and  
adjusted for bonnet length

ORMEAU ROAD (30mph)

Area for which  
visibility is  
being sought.

Existing parking bays

Existing parking bays

Revision	Date	Revised by	Checked by
REV A	BEC 2022	PER	PER

Project: **AMEND - Apartment to the area subject to abandonment request**

**Alastair Coe Architects**  
 HISTORIC BUILDINGS SPECIALISTS  
 Address: 14-16, The Quadrant, Belfast, BT1 1PL, Northern Ireland  
 Tel: 01232 724111 Fax: 01232 724112 Email: alastair@alastaircoe.com

Project Reference: **EIP06**  
 Drawing Number: **AO-02**

Scale: 1:500  
 Date: 14 SEP 2022  
 Drawn by: PER  
 Checked by: PER

Project: **REFURBISHMENT OF THE ERRIGLE INN**  
 at 312 - 320 ORMEAU ROAD  
 for PHIL MCGURRAN  
**Existing street plan**  
**Impact of sought area**  
**on visibility splays**

Existing street plan SCALE 1:100